

HAMPTON BAY®



Cabinets Shown In **Sinclair Light Oak**

Cabinets designed for the way you live.



Cabinetry by HAMPTON BAY®



When you want your space to be as beautiful as it is functional, choose Hampton Bay. With an on-trend selection of styles at affordable price points, you'll never have to compromise.

1

FIND YOUR STYLE

Discover the look and feel you love, then bring it to life by choosing from our selection of door styles and finishes. We have exactly what you need to customize your space for your unique vision and lifestyle.

2

DESIGN YOUR SPACE

Ready to make it happen? Create your new space on your own, or work with one of our experienced designers. Visit [HomeDepot.com](https://www.homedepot.com) to explore more resources that will ensure your success.

3

PLACE YOUR ORDER

You're ready for cabinets! Home Depot stores offer in-stock cabinets that are ready to pick-up. Work with an in-store designer to place your order, or you can order online directly from [HomeDepot.com](https://www.homedepot.com).

In-Stock

When you need your cabinets now, create your space with our in-stock selection of standard size cabinets and take them home today. Finishes vary by store.

HomeDepot.com

You can find our full assortment of specialty cabinets, door styles, finishes and accessories online. The best part? They ship to a store or directly to your home in just one day. See [HomeDepot.com](https://www.homedepot.com) for delivery details.

Special-Order

For our expanded options of specialty cabinets, you can create a special order through your Home Depot store. Your shipment will reach the store in two to three weeks. A five-cabinet minimum applies to special orders only.

Product Details

Product details can be found on pages 18–23, with more details on [HomeDepot.com](https://www.homedepot.com).



HomeDepot.com

75+ Cabinet Sizes Available in All Finishes

SHIPS IN 1 DAY



SELECT YOUR DOOR STYLE & FINISH

Shaker

Clean & Modern

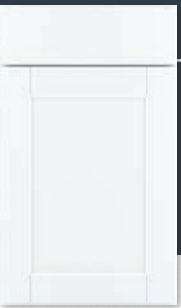

Satin White ①
Full Overlay
Finish Code: SSW



Dove Gray ①
Full Overlay
Finish Code: SDV



Java ②
Full Overlay
Finish Code: SJM

Sinclair

Warm & Welcoming



Light Oak ②
Full Overlay
Finish Code: SLO



Saddle Oak ②
Full Overlay
Finish Code: SSB

Hampton

Detailed & Traditional



Satin White ①
Full Overlay
Finish Code: SW

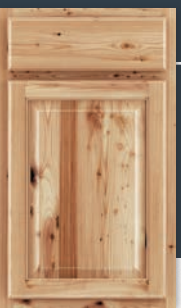

Natural Hickory ②
Traditional Overlay
Finish Code: NHK



Medium Oak ②
Traditional Overlay
Finish Code: MO

Unfinished

A Blank Canvas

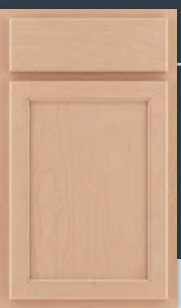

Traditional Overlay
Ready to stain or paint

① Thermofoil ② Stained

- ✓ Cabinets ship in just one day when ordered through [HomeDepot.com](https://www.homedepot.com). Simply search by door name.
- ✓ Enjoy quality construction. See p.17 for details.
- ✓ Create a custom look by adding specialty cabinets to your design.
- ✓ Go beyond the kitchen—our cabinets work beautifully for laundry, bath, storage, entertainment and other spaces.



Sinclair Light Oak & Saddle Oak

SINCLAIR LIGHT OAK

Our Sinclair Light Oak finish features a Shaker door in a calming, neutral shade that works beautifully alone or when paired with other finishes. From refined to rustic, Light Oak can suit any living space.



[VIEW COLLECTION](#)



SINCLAIR SADDLE OAK

Ground your space with our warm Sinclair Saddle Oak finish. This Shaker door features distinctive grain patterns and a rich brown tone, offering classic appeal with a welcoming feel.



[VIEW COLLECTION](#)



SHAKER SATIN WHITE

Island shown in Shaker Dove Gray



VIEW COLLECTION

For a look that will never go out of style, create a backdrop of beautiful Shaker White cabinets and add a Shaker Dove Gray island. Bright but grounded, you'll feel right at home spending time with family or entertaining friends.



Everything In Its Place

When you're juggling work and family, you need a kitchen that works as hard as you do. Our range of flex cabinets, pullout trays, and more keeps you thoughtfully organized, so you can spend more time on the things that matter most.

SHAKER DOVE GRAY

Shaker Dove Gray offers classic appeal that can elevate any room. Create an inviting space that has clean lines and an open, spacious feel.



VIEW COLLECTION



SHAKER JAVA

Our striking Shaker Java collection balances beauty and simplicity. Give your home a warm yet modern look, then add all the details that make it your own.



VIEW COLLECTION





HAMPTON NATURAL HICKORY

When you want a space that's inviting and warm, choose our Hampton Natural Hickory finish. Rustic and brimming with character, it makes any space feel welcoming.



[VIEW COLLECTION](#)



HAMPTON SATIN WHITE

Do you feel at home in spaces that are bright and airy? From a refreshing coastal feel to a more traditional style, create a calm and neutral environment with Hampton Satin White.



[VIEW COLLECTION](#)



HAMPTON MEDIUM OAK

If you're most at peace in the great outdoors, our Medium Oak finish will bring that same breath of fresh air inside. Add the natural beauty of wood to any living space for a timeless look.



VIEW COLLECTION



Painted in Behr® Green Balsam

UNFINISHED

Whether you're looking to stain, paint, or have the freedom to mix and match multiple finishes, bring your unique vision to life with our Unfinished cabinets. Complete with fully-finished interiors, they're offered at an affordable price point.



VIEW COLLECTION



CREATE THE LOOK OF A CUSTOM KITCHEN AND ADD ORGANIZATION WITH FLEX CABINETS AND SPECIALTY SKUs



SEAMLESSLY MAXIMIZE STORAGE SPACE WITH FLEX CABINETS

Durable and easy to install, Hampton Bay's flex cabinetry not only gives you more storage options, but also adds visual interest to your kitchen. Whether you're storing wine bottles above a wet bar or extra china in your island, you'll enjoy the convenience of easy access and an on-trend appearance.

Choose a wall cabinet with configurable shelves and dividers (Model #KWFC1830) or an open wall cabinet with a microwave shelf and dividers (Model #KWFC3018).



MODEL #KWFC1830



MODEL #KWFC3018



Shaker Satin White & Dove Gray

CREATE UNIQUE DESIGNS WITH SPECIALTY SKUs

Whenever you're working with an unconventional space, look to Hampton Bay's speciality SKUs to bring your vision to life. We offer a range of options that can suit any size space to create cabinetry that meets your needs. For example, when you're working with a particularly narrow space, you can use wall cabinets as bases.

- A** Apron Front Sink Base Cabinet
- B** Heavy-Duty Sliding Drawers
- C** Double Oven Cabinet
- D** Overhead Deep Bridge Cabinet
- E** Fit to Size Island End Kit w/Decorative Panels
- F** Flex Cabinets
- G** 42" Tall Cabinets
- H** Waste Bin Cabinet
- I** 96" Pantry



CREATE ANY LIVING SPACE QUICKLY AND EASILY

You can add style and storage to any room in your home, so why stop with the kitchen? Whether you want a spacious mudroom, a luxe laundry room, or a home office that's sure to inspire productivity, design your new favorite room with Hampton Bay.



USE BUILT-IN BATH CABINETRY TO CREATE YOUR DREAM BATHROOM

With our range of bath cabinets available in on-trend finishes, you can design a built-in bath to fit any space—from a powder room to a master bath. Combine cabinets to create a configuration that maximizes your space and provides plenty of storage.



Scan to get started with our online planner



12" Bath Drawer Base
KVDB12



15" Bath Drawer Base
KVDB15



18" Bath Drawer Base
KVDB18



24" Bath Sink Base
KVSB24



30" Bath Sink Base
KVSB30



36" Bath Sink Base
KVSB36

Wall Cabinet



- A** Face-frame construction, 3/4" thick, 1 1/2" wide for solid and durable cabinets.
- B** Metal shelf clips for heavy loads.
- C** Fully concealed and adjustable hinges provide a clean look.
- D** Single door cabinet doors can be reversed to open left or right. Double door cabinets are full access, no center stile.
- E** Finished cabinets include 1/2" thick engineered side panels for durability and color exterior to match cabinet. Unfinished cabinets include 1/2" thick engineered side panels and raw exterior finish.
- F** 3/4" thick adjustable shelves for heavy loads. Wall cabinets include full-depth shelves and base cabinets include half-depth shelf to allow for taller items.

Base Cabinet



- G** Maple laminate interior is easy to clean.
- H** Finished cabinets feature ball-bearing drawer glides for smooth operation and durability. Unfinished cabinets have epoxy glides.
- I** Hardwood four-sided drawer box with fully encapsulated bottom panel for added strength.
- J** 3/8" fully encapsulated bottom and back panels for extra strength and easy installation. Sink base back panel must be cut for plumbing access.

Note: Order matching toe kick separately

CABINET SELECTION

Wall Cabinets

Wall cabinets are 12"D unless noted

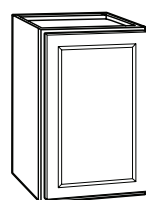

Wall	30"H	36"H	42"H
9"W	9"W	12"W	
12"W	12"W	15"W	
15"W	15"W	18"W	
18"W	18"W	21"W	
21"W	21"W	24"W	
24"W	24"W		

- FINISHED DOOR STYLES:
- Include two adjustable shelves
- UNFINISHED DOOR STYLE:
- Includes one adjustable shelf

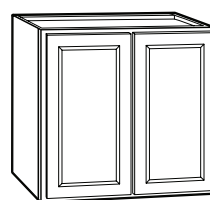

Wall	30"H	36"H	42"H
27"W	27"W	27"W	
30"W	30"W	30"W	
33"W	33"W	33"W	
36"W	36"W	36"W	

- FINISHED DOOR STYLES:
- Include two adjustable shelves
- UNFINISHED DOOR STYLE:
- Includes one adjustable shelf

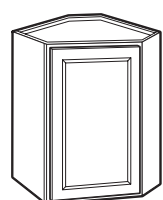

Corner Wall	30"H	36"H	42"H
24"W	24"W	24"W	

- Installs in a 24" x 24" wall area
- FINISHED DOOR STYLES:
- 30" height includes one adjustable shelf
 - 36" and 42" heights include two adjustable shelves
- UNFINISHED DOOR STYLE:
- Includes one adjustable shelf

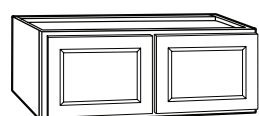
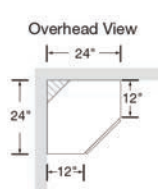

Wall Bridge	12"H	15"H	18"H
30"W	30"W	30"W	
36"W	36"W	36"W	

No shelf included

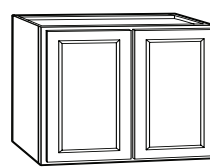

Tall Wall Bridge	23 1/2"H
30"W	
30"W x 15"D	
36"W	

- FINISHED DOOR STYLES:
- Include one adjustable shelf
- UNFINISHED DOOR STYLE:
- No shelf

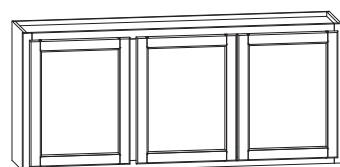

Wide Wall Bridge	23 1/2"H
54"W	

Includes one shelf

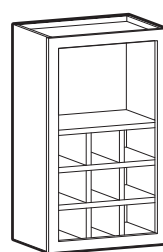

Wall Flex	30"H
18"W	

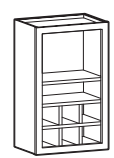
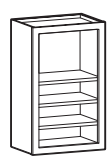

Open Shelves Organizer Cubes

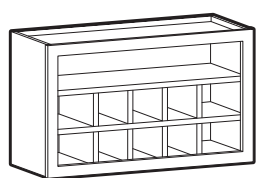

Wall Flex	18"H
30"W	

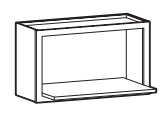

Microwave Shelf included



Open Shelves

Wall Flex cabinets come with the shelves and dividers to configure them your way. Our flex cabinets have finished matched interiors.

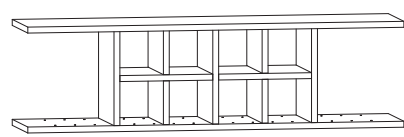

Wall Flex Shelf	13 3/8"H
48"W	

Ready to Assemble. Trimable and configurable. The Wall Flex Shelf requires installation assembly.

◆ Available in finished cabinetry only.
◇ Available in unfinished cabinetry only.

CABINET SELECTION

Base Cabinets

Base cabinets are 24"D and 34 1/2"H unless noted

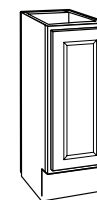

Base	9"W
Includes one half-depth adjustable shelf	

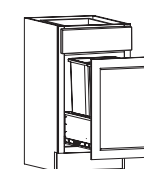

Dual Waste Bin	18"W
Includes two 35-quart wastebaskets	

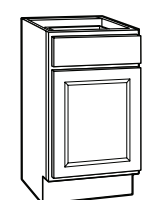

Base	12"W	15"W	18"W	21"W	24"W
Includes one half-depth adjustable shelf					

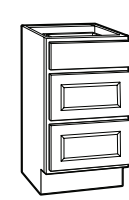

Kitchen Drawer Base	18"W	24"W
---------------------	------	------

Vanity Drawer Base	12"W x 21"D	15"W x 21"D	18"W x 21"D
--------------------	-------------	-------------	-------------

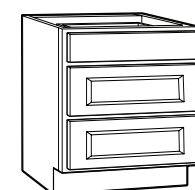

Pots & Pans Drawer Base	30"W	36"W
Includes heavy duty drawer glides		

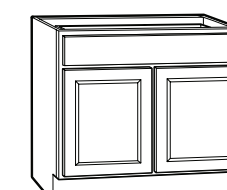

Base	27"W	30"W	33"W	36"W
Includes one half-depth adjustable shelf				

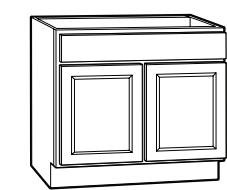

Sink/Cooktop Base	30"W	33"W	36"W
-------------------	------	------	------

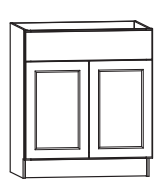

Vanity Base	24"W x 21"D	30"W x 21"D	36"W x 21"D
-------------	-------------	-------------	-------------

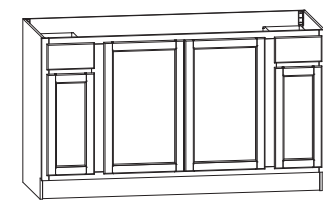

Sink/Cooktop	60"W
--------------	------

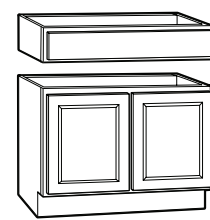

Accessible Sink Base	36"W
----------------------	------

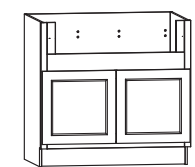

Apron Front Sink Base	36"W
-----------------------	------

Cut-out dimensions:
W: 29" minimum, 33" maximum
H: 7 1/2" minimum, 11" maximum

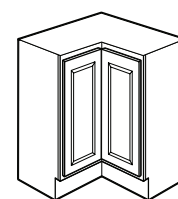

Corner Base with Lazy Susan

Installs in a 36" x 36" wall area

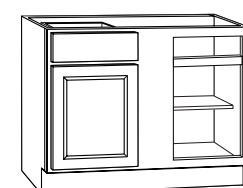
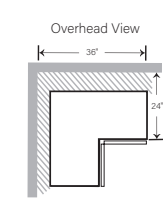

Blind Base	36"W
Pull distance 42" minimum 45" maximum	
Includes one half-depth adjustable shelf	

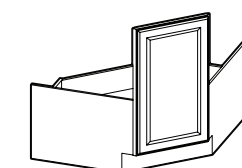
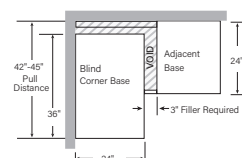

Corner Sink Base	36"W
------------------	------

Ready to assemble

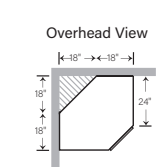

Pantry Cabinets

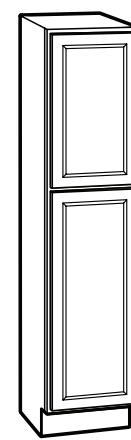

Pantry	18"W	84"H	90"H	96"H
--------	------	------	------	------

- FINISHED:
- Includes three adjustable shelves and one fixed shelf
- UNFINISHED:
- Includes two adjustable shelves and one fixed shelf

Minor assembly of toe kick is required on 96"H pantry, included.

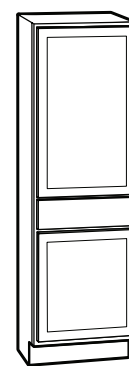

Drawer Pantry	24"W	84"H x 18"D
---------------	------	-------------

Available in stores only

Features 2 doors, 1 drawer and 2 adjustable shelves

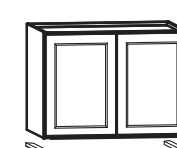

Double Oven Cabinet	33"W	84"H x 24"D	90"H x 24"D	96"H x 24"D
---------------------	------	-------------	-------------	-------------

Includes separate bridge cabinet

Oven cabinet comes in 2 parts for easy installation

Cut-out dimensions:
W: 24" minimum, 30" maximum
H: 47 5/8" minimum, 52 1/8" maximum

Includes bottom drawer

Oven Cabinets

Refrigerator Cabinets

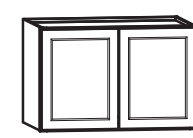

Deep Bridge Cabinet	36"W x 24"D	12"H	18"H	23 1/2"H
---------------------	-------------	------	------	----------

Must be attached with 3 points of contact – back wall studs, side wall and/or cabinets on both sides.



Refrigerator End Panel	24"D
------------------------	------

84"H x 24"D x 1 1/2"W
90"H* x 24"D x 1 1/2"W
96"H* x 24"D x 1 1/2"W

*84" Refrigerator End Panel includes 2 additional panels that extend reach to heights of 90" and 96"H.

◆ Available in finished cabinetry only.
◇ Available in unfinished cabinetry only.

ACCESSORY SELECTION

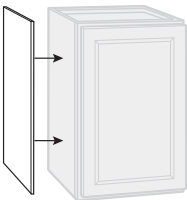

Veneer End Panel

Wall
30"H
36"H
42"H

Base
34 1/2"H
Island/Peninsula
48"W x 34 1/2"H

Pantry
24"W x 84"H
24"W x 90"H

Base Model #KAS2435-YY
Wall Model #KAS1230-YY

Finished veneer panels fit flush. Satin White and Dove Gray panels are laminate.

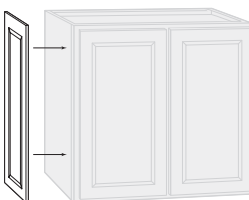

Decorative End Panel

Wall
30"H
Model #KAEP1230-YY
30"H x 18"W
Model #KAEP1830-YY
36"H
Model #KAEP1236-YY
42"H
Model #KAEP1242-YY

Base
34 1/2"H
Model #KAEP2430-YY

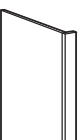

Dishwasher End Panel
1 1/2"W x 34 1/2"H x 24"D
Model #KADEP-YY



Decorative Island Panel Kit
3"W x 34 1/2"H x 37 1/2"D
1 post ships loose. Panel can be cut to accommodate different depths.
Model #KADPK337-YY

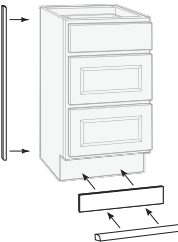

Scribe Molding
91 1/2"L
Model #KAMSX-YY

Toe Kick Molding
91 1/2"L x 4 1/2"H
Model #KATKX-YY

Shoe Trim Molding
91 1/2"L
Model #KAMTX-YY

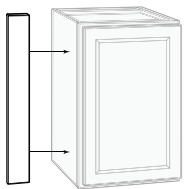

Filler
30"H 36"H 42"H
3"W 3"W 3"W
6"W 6"W 6"W
Model #KAFS330X-YY

Pantry Filler
91 1/2"H
3"W
Model #KAFS396X-YY

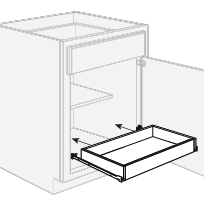

Ready to Assemble Pull-Out Drawer
3 1/4"H x 20 1/2"D
Model #KADRTA12 Fits 12" Base
Model #KADRTA15 Fits 15" Base
Model #KADRTA18 Fits 18" Base/Pantry
Model #KADRTA24 Fits 24" Base/Pantry
Model #KADRTA27 Fits 27" Base
Model #KADRTA30 Fits 30" Base



Decorative Corner Post
34 1/2"H
Model #KADCP6-YY

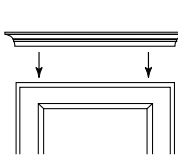

Crown Molding
91 1/2"L
Traditional
Model #KAMC5X-YY
Shaker
Model #KAMC4X-YY



48" Universal Panel
48"L x 3/4"H x 11 1/4"D
Laminate finish on 5 sides.
Model #KAUP1148-YY

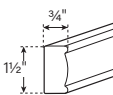

Decorative Edge Molding
91 1/2"L
Model #KAMDEX-YY

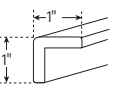

Outside Corner Molding
91 1/2"L
Model #KAOCMX-YY



60" Universal Panel
60"L x 3/4"H x 12"D
Laminate finish on 5 sides.
Model #KAUP1260-YY

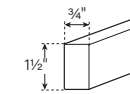

Square Edge Molding
91 1/2"L
Model #KAMSQX-YY

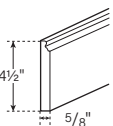

Decorative Base Molding
91 1/2"L
Model #KAMBSX-YY

GET STARTED WITH DESIGN & LAYOUT

FOUR WAYS TO TURN THE CORNER

1 Lazy Susan Option

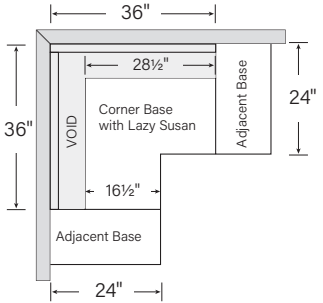

2 Block Out Option

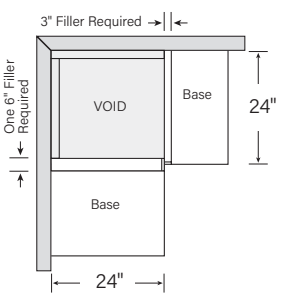

3 Blind Base Option

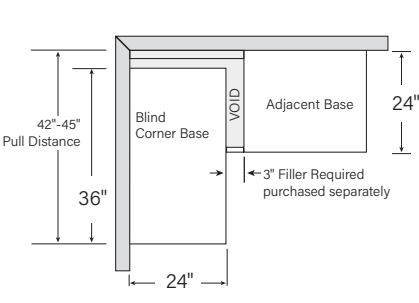

4 Corner Base Option

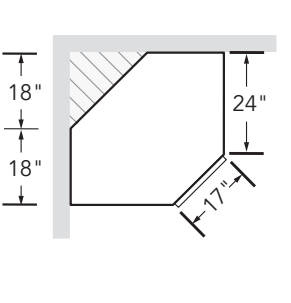

DISTINCTIVE LAYOUTS WITH DIFFERENT WALL CABINET HEIGHTS

Create a unique look and feel for your home. These layouts are based on typical eight-foot ceilings and are designed to provide the most storage possible.

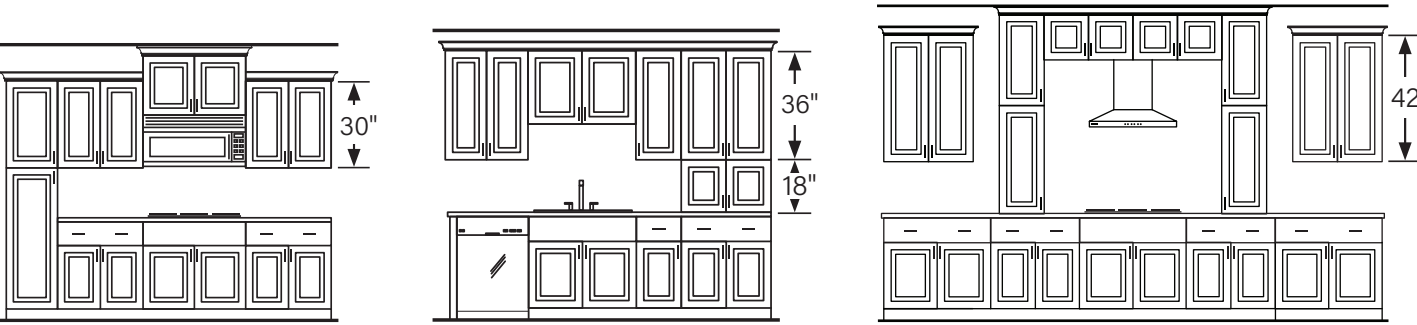

Maximize storage with taller walls and pantries. Refer to Spec Guide for additional notes on cabinet pairings.

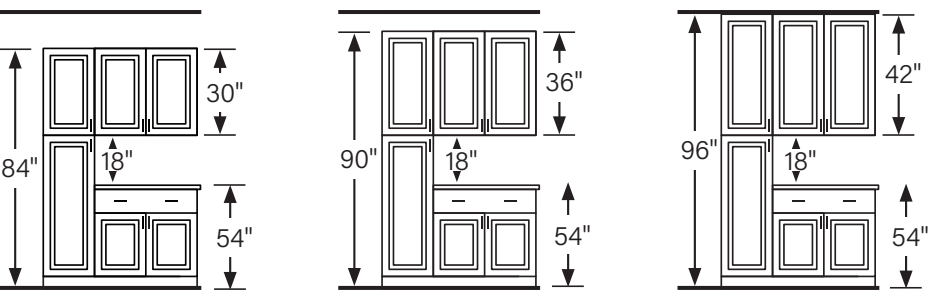

Visit us at [HamptonBayKitchens.com](https://hamptonbaykitchens.com) for more inspiration.

◆ Available in finished cabinetry only.
◇ Available in unfinished cabinetry only.

CABINET MODEL NUMBERS

Find and order cabinets and accessories on **HomeDepot.com** using Model #'s below.

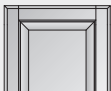
SHAKER 			SINCLAIR 		HAMPTON 		
Satin White (RTF) YY=SSW	Dove Gray (RTF) YY=SDV	Java YY=JM	Light Oak YY=SLO	Saddle Oak YY=SSB	Natural Hickory YY=NHK	Medium Oak YY=MO	Satin White (RTF) YY=SW

Wall Cabinets

(12"D unless noted)

WALL		MODEL #
30"H	9"W	KW930-YY
	12"W	KW1230-YY
	15"W	KW1530-YY
	18"W	KW1830-YY
	21"W	KW2130-YY
	24"W	KW2430-YY
	27"W	KW2730-YY
	30"W	KW3030-YY
	33"W	KW3330-YY
	36"W	KW3630-YY
36"H	9"W	KW936-YY
	12"W	KW1236-YY
	15"W	KW1536-YY
	18"W	KW1836-YY
	21"W	KW2136-YY
	24"W	KW2436-YY
	27"W	KW2736-YY
	30"W	KW3036-YY
	33"W	KW3336-YY
	36"W	KW3636-YY
42"H	12"W	KW1242-YY
	15"W	KW1542-YY
	18"W	KW1842-YY
	21"W	KW2142-YY
	24"W	KW2442-YY
	27"W	KW2742-YY
	30"W	KW3042-YY
	33"W	KW3342-YY
	36"W	KW3642-YY
CORNER WALL (Installs in a 24" x 24" wall area)		
30"H	24"W	KWD2430-YY
36"H	24"W	KWD2436-YY
42"H	24"W	KWD2442-YY
WALL BRIDGE		
12"H	30"W	KW3012-YY
	36"W	KW3612-YY
15"H	30"W	KW3015-YY
	36"W	KW3615-YY
18"H	30"W	KW3018-YY
	36"W	KW3618-UF
23 1/2"H	30"W	KW3024-YY
	30"W x 15"D	KW302415-YY
	36"W	KW3624-YY
WALL FLEX		
18"H	30"W	KWFC3018-YY
30"H	18"W	KWFC1830-YY
WALL FLEX SHELF - Ready to Assemble		
13 3/8"H	48"W	KWMS4813-YY

Base Cabinets

(34 1/2"H x 24"D unless noted)

BASE	MODEL #
9"W	KBF09-YY
12"W	KB12-YY
15"W	KB15-YY
18"W	KB18-YY
21"W	KB21-YY
24"W	KB24-YY
27"W	KB27-YY
30"W	KB30-YY
33"W	KB33-YY
36"W	KB36-YY
WASTE BIN BASE - Includes two 35-quart wastebaskets	
18"W	KBWD18-YY
DRAWER BASE	
18"W	KDB18-YY
24"W	KDB24-YY
POTS & PANS DRAWER BASE	
30"W	KDB30-YY
36"W	KDB36-YY
SINK/COOKTOP BASE	
30"W	KSB30-YY
33"W	KSB33-YY
36"W	KSB36-YY
APRON FRONT SINK BASE	
36"W	KSBD36-YY
ACCESSIBLE SINK BASE	
36"W	KSBA36-YY
CORNER SINK BASE - Ready to Assemble	
36"W	KCSB36-YY
BLIND BASE	
36"W	KBBC45-YY
CORNER BASE WITH LAZY SUSAN (Installs in a 36" x 36" wall area)	
	KBLS36-YY

Specialty Cabinets

PANTRY (24"D)		MODEL #
18"W	84"H	KP1884-YY
	90"H	KP1890-YY
	96"H	KP1896-YY
DOUBLE OVEN		
33"W	84"H	KDV3384-YY
	90"H	KDV3390-YY
	96"H	KDV3396-YY
REFRIGERATOR END PANEL KIT		
24"D	84"H	KAREP-YY
DEEP BRIDGE CABINET (24"D) To be used with Refrigerator End Panel		
36"W	12"H	KW361224-YY
36"W	18"H	KW361824-YY
36"W	24"H	KW362424-YY
VANITY CABINETS (21"D)		
Vanity Drawer Base		
12"W	34 1/2"H	KVDB12-YY
15"W	34 1/2"H	KVDB15-YY
18"W	34 1/2"H	KVDB18-YY
Vanity Base		
24"W	34 1/2"H	KVSB24-YY
30"W	34 1/2"H	KVSB30-YY
36"W	34 1/2"H	KVSB36-YY
DECORATIVE END PANELS (See accessories page for a broader selection)		
Decorative Wall 12"W x 30"H		KAEP1230-YY
Decorative Wall 15"W x 30"H		KAEP1530-YY
Decorative Wall 18"W x 30"H		KAEP1830-YY
Decorative Wall 12"W x 36"H		KAEP1236-YY
Decorative Wall 12"W x 42"H		KAEP1242-YY
Decorative Base 24"W x 30"H		KAEP2430-YY

ACCESSORY FINISH CODES

Satin White (RTF) YY=SW	Dove Gray (RTF) YY=DV	Light Oak YY=SLO	Saddle Oak YY=SSB
Java YY=JM	Natural Hickory YY=NHK	Medium Oak YY=MO	

Accessories

END PANELS	MODEL #
Wall Veneer 30"H (2/pack)	KAS1230-YY
Wall Veneer 36"H (2/pack)	KAS1236-YY
Wall Veneer 42"H (2/pack)	KAS1242-YY
Base Veneer (2/pack)	KAS2435-YY
Island/Peninsula Panel 48"W	KAIE4835X-YY
Dishwasher End Panel	KADEP-YY
Universal Panel 48" x 11 1/4"	KAUPT148-YY
Universal Panel 60" x 12"	KAUPI260-YY
Decorative End Panels	See Specialty Cabinets
FILLERS	
3"W x 30"H	KAFS330X-YY
6"W x 30"H	KAFS630X-YY
3"W x 36"H	KAFS336X-YY
6"W x 36"H	KAFS636X-YY
3"W x 42"H	KAFS342X-YY
6"W x 42"H	KAFS642X-YY
3"W x 91 1/2"H	KAFS396X-YY
DRAWERS AND MOLDINGS	
Ready to Assemble Pull-Out Drawer 12"	KADRTA12
Ready to Assemble Pull-Out Drawer 15"	KADRTA15
Ready to Assemble Pull-Out Drawer 18"	KADRTA18
Ready to Assemble Pull-Out Drawer 21"	KADRTA21
Ready to Assemble Pull-Out Drawer 24"	KADRTA24
Ready to Assemble Pull-Out Drawer 27"	KADRTA27
Ready to Assemble Pull-Out Drawer 30"	KADRTA30
Toe Kick Molding 91 1/2"L *	KATKX-YY
Shoe Trim Molding 91 1/2"L	KAMTX-YY
Scribe Molding 91 1/2"L	KAMSX-YY
Traditional Crown Molding 91 1/2"L	KAMC5X-YY
Shaker Crown Molding 91 1/2"L	KAMC4X-YY
Base Molding 91 1/2"L	KAMBSX-YY
Outside Corner Molding 91 1/2"L	KAOCMX-YY
Square Edge Molding 91 1/2"L	KAMSQX-YY
Decorative Edge Molding 91 1/2"L	KAMDEX-YY
DECORATIVE ACCESSORIES	
Decorative Island Panel Kit	KADPK337-YY
Decorative Corner Post	KADCP6-YY

*Required accessory to complete your project

In-stock selection varies by store. Special Orders deliver to the store within 2 weeks. 5 cabinet minimum applies to Special Orders. No minimum for accessory-only orders.

UNFINISHED

Unfinished YY=UF

Wall Cabinets

(12"D unless noted)

WALL		MODEL #
30"H	9"W	KW930-UF
	12"W	KW1230-UF
	15"W	KW1530-UF
	18"W	KW1830-UF
	21"W	KW2130-UF
	24"W	KW2430-UF
	27"W	KW2730-UF
	30"W	KW3030-UF
36"H	36"W	KW3630-UF
	9"W	KW936-UF
	12"W	KW1236-UF
	15"W	KW1536-UF
	18"W	KW1836-UF
	21"W	KW2136-UF
	24"W	KW2436-UF
	27"W	KW2736-UF
36"H	30"W	KW3036-UF
	36"W	KW3636-UF
CORNER WALL (Installs in a 24" x 24" wall area)		
30"H	24"W	KWD2430-UF
36"H	24"W	KWD2436-UF
WALL BRIDGE		
12"H	30"W	KW3012-UF
	36"W	KW3612-UF
15"H	30"W	KW3015-UF
	36"W	KW3615-UF
18"H	30"W	KW3018-UF
	36"W	KW3618-UF
23 1/2"H	30"W	KW3024-UF
	30"W x 15"D	KW302415-UF
	36"W	KW3624-UF
24"H	54"W	KW5424-UF

Base Cabinets

(34 1/2"H x 24"D unless noted)

STANDARD BASE	
9"W	KBF09-UF
12"W	KB12-UF
15"W	KB15-UF
18"W	KB18-UF
21"W	KB21-UF
24"W	KB24-UF
27"W	KB27-UF
30"W	KB30-UF
36"W	KB36-UF

Base Cabinets

(34 1/2"H x 24"D unless noted)

DRAWER BASE		
	18"W	KDB18-UF
	24"W	KDB24-UF
SINK/COOKTOP BASE		
	30"W	KSB30-UF
	36"W	KSB36-UF
	60"W	KSBF60-UF
ACCESSIBLE SINK BASE		
	36"W	KSBA36-UF
CORNER SINK BASE - Ready to Assemble		
	36"W	KCSB36-UF
BLIND BASE		
	36"W	KBBC45-UF
CORNER BASE WITH LAZY SUSAN (Installs in a 36" x 36" wall area)		
		KBLSN36-UF
PANTRY (18"W are 24"D, 24"W are 18"D)		
18"W	84"H	KP1884-UF
	90"H	KP1890-UF
24"W	84"H	KPDR2484-UF

Accessories

END PANELS	
Wall Veneer 30"H*	KASKW30-UF (1/pack)
Wall Veneer 36"H*	KASKW36-UF (1/pack)
Base Veneer*	KASKB35-UF (1/pack)
Utility Veneer 84**	KASKP84-UF
Utility Veneer 90**	KASKP90-UF
Dishwasher End Panel	KADEP-UF
FILLERS	
3"W x 30"H	KAFS330X-UF
6"W x 30"H	KAFS630X-UF
3"W x 36"H	KAFS336X-UF
6"W x 36"H	KAFS636X-UF
3"W x 91 1/2"H	KAFS396X-UF
MOLDINGS	
Toe Kick 91 1/2"L *	KATKX-UF
Shoe Trim 91 1/2"L	KAMTX-UF
Scribe 91 1/2"L	KAMSX-UF
Crown 91 1/2"L	KAMC5X-UF
Corner 91 1/2"L	KAOCMX-UF

HAMPTON BAY®

1-888-578-4009

HamptonBayKitchens.com

SCAN TO VISIT
HamptonBaykitchens.com



IMPORTANT INFORMATION

KCMA certifications are for finished cabinetry only.

KITCHEN CABINET MANUFACTURERS ASSOCIATION. ENVIRONMENTAL STEWARDSHIP PROGRAM (ESP). ALL PRODUCTS IMPACT THE ENVIRONMENT. FOR ESP PROGRAM CRITERIA, VISIT KCMA.ORG. Applicable to Finished and Unfinished cabinetry.

The photography and color samples pictured in this book have been reproduced as accurately as printing technology permits and are for general representation only. To ensure the highest satisfaction, we strongly recommend that you view an actual product sample or order a door sample on HomeDepot.com.

Every effort was made to ensure accuracy of the information contained herein at the time of printing; however, Hampton Bay makes no representations to such accuracies. For additional disclosures, see a store associate or contact the customer service department for Hampton Bay at 1-888-578-4009.

Copyright © 2025 American Woodmark Corporation®. All Rights Reserved. THE HOME DEPOT® is a registered trademark of Home Depot LLC, Inc. HAMPTON BAY® is a registered trademark of Home Depot Product Authority, LLC.

